

PROJECT :
PROPOSED B+2 COMMERCIAL BLOCK AT JOYVILLE-AFFORDABLE HOUSING, HOWRAH

AREA STATEMENT

GROUND FLOOR AREA 921.354 SQ.M.
 FIRST FLOOR AREA 890.697 SQ.M.
 SECOND FLOOR AREA 910.857 SQ.M.
 TOTAL AREA 2722.908 SQ.M.

KEY PLAN

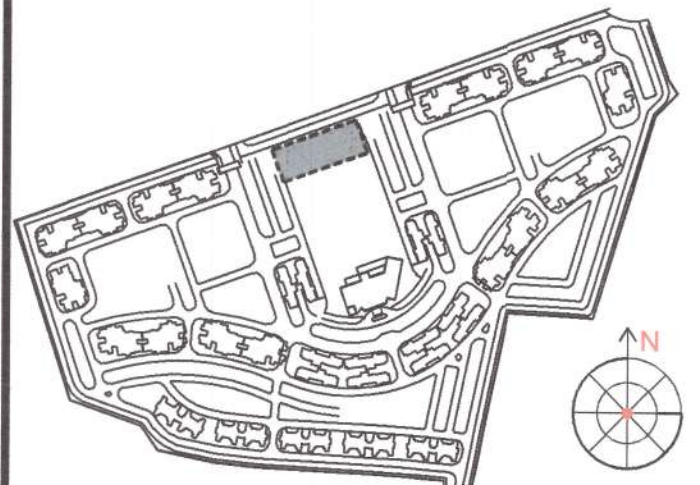

THE STRUCTURAL DESIGN & DRAWINGS OF BOTH FOUNDATION & SUPERSTRUCTURE OF THE BUILDING HAS BEEN MADE BY ME CONSIDERING ALL POSSIBLE LOADS INCLUDING THE SEISMIC LOAD AS PER THE NATIONAL BUILDING CODE OF INDIA CERTIFIED THAT IT IS SAFE AND STABLE IN ALL RESPECT.

SANJIV J. PAREKH
 M.E. (STRUCT.), M.E. (CONST. ENG.),
 B. C. E., FIE-(F-018202-4)
 E. S. E. NO. 104 (I) K. M. C.

SIGNATURE OF STRUCTURAL ENGINEER

THE PLOT HAS BEEN INSPECTED BY ME AND ON THAT BASIS I DO CERTIFY WITH FULL RESPONSIBILITY THAT THE PROPOSED BUILDING PLAN HAS BEEN DRAWN AS PER PROVISION OF K.M.D.A. DEVELOPMENT CONTROL REGULATIONS & BUILDING BYE LAWS FOR KOLKATA WEST INTERNATIONAL CITY.

SUTANU GHATACHARYA
 Registered Architect
 Council of Architecture
 Regn. No. CA/92/15324

SIGNATURE OF ARCHITECT

CLIENT: **KOLKATA WEST INTERNATIONAL CITY SALAP MORE, HOWRAH**

DESIGN ASSOCIATE (ARCH, STR & MEP)
SHAPOORJI PALLONJI ENGINEERING & CONSTRUCTION

CONTENT : **GROUND FLOOR PLAN**

SCALE 1:100 DRG. NO. SBA/KWIC/COMM/SANC-02
 DATE 31.07.2020
 DEALT
 CHKD.

SCHEDULE OF OPENINGS

DOOR SCHEDULE						
S.NO	TYPE	WIDTH	HEIGHT	CLL LVL	LINTEL HT	REMARKS
1	D1	1500	2400	+50	+2450	ANCHOR SHOP
2	D2	1200	2100	+50	+2150	KITCHEN
3	D3a	1050	2100	+50	+2150	TOILET DOOR
4	D4	900	2100	+50	+2150	ELECTRICAL SERVICES
5	D4a	900	2100	+50	+2150	TOILETS DOOR
6	D5	1800	2400	+50	+2450	SHOPS, RESTAURANT DOOR
7	D5a	1500	2400	+50	+2450	SHOPS
8	D5b	1500	2200	+250	+2450	SHOPS, RESTAURANT DOOR
9	D5c	1050	2400	+50	+2450	SHOPS DOOR
10	SD1	1000	1500	+500	+2100	FHC SHAFT DOOR
11	SD2	900	1500	+500	+2150	ELV SHAFT DOOR
1	RS1	3700	-	+50	+2450	ROLLING SHUTTER
2	RS2	3100	-	+50	+2450	ROLLING SHUTTER
3	RS3	1800	-	+50	+2450	ROLLING SHUTTER

WINDOW SCHEDULE						
S.NO	TYPE	WIDTH	HEIGHT	CLL LVL	LINTEL HT	REMARKS
1	W1	1500	1400	+1050	+2450	STAIRCASE, KITCHEN
2	W2	1200	1400	+1050	+2450	SERVICES
3	V1	900	1200	+1350	+2450	TOILETS
4	V2	900	900	+1350	+2450	TOILETS

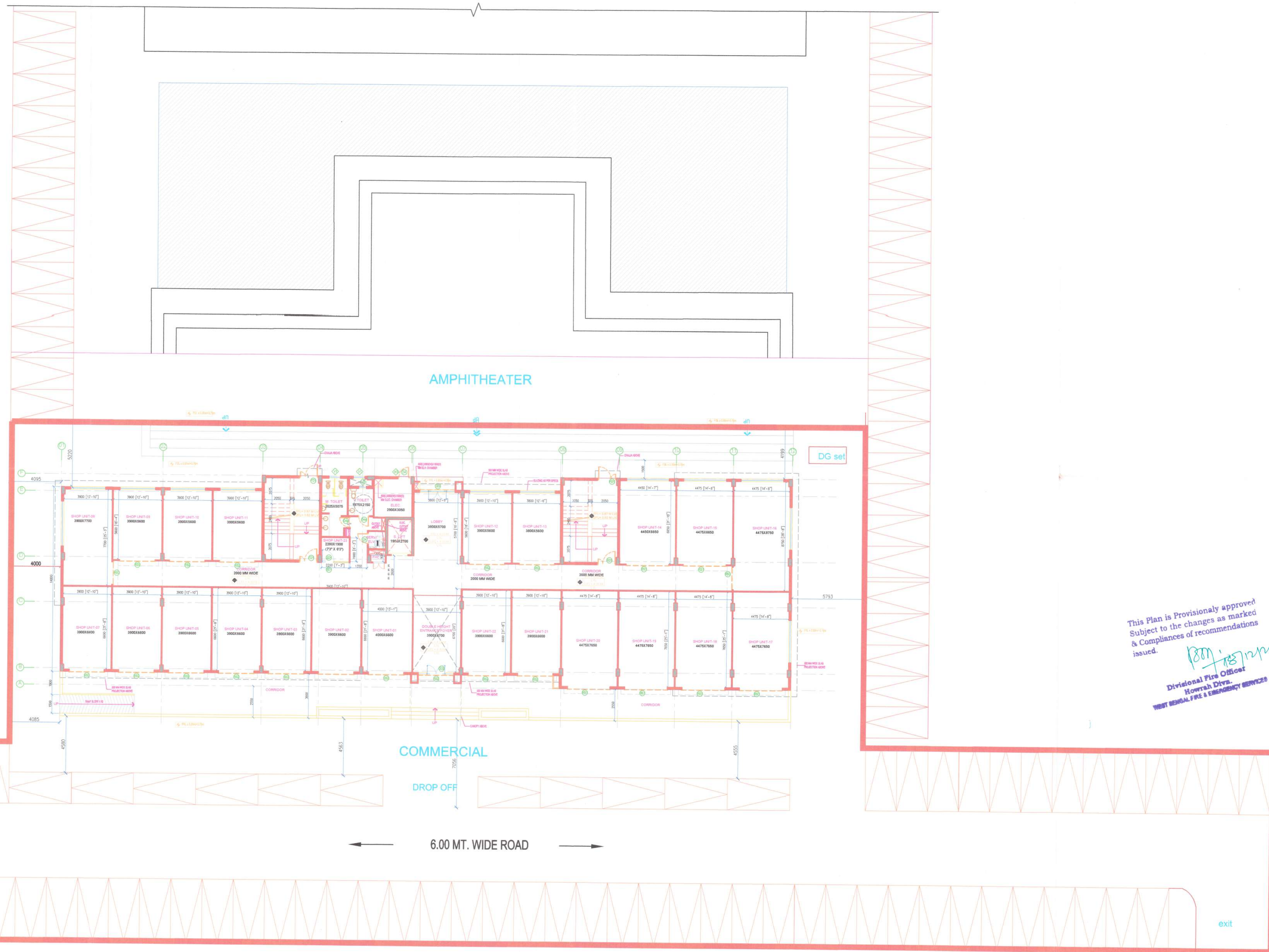

This Plan is Provisionally approved
 Subject to the changes as marked
 & Compliances of recommendations
 issued.
 18.07.2020
 Divisional Fire Officer
 Howrah Divn.
 WEST REGIONAL FIRE & EMERGENCY SERVICES

GROUND FLOOR PLAN